



SAMANTHA WILSON

PROPERTY



15 Mahers Lane TERRANORA NSW

3  2  3 

This warm and inviting family home was designed and built by the owners in 1986. Since that time regular maintenance and renovations has ensured it remains relevant to today's market.

The home was designed to take advantage of the beautiful and natural Terranora landscape and has been an entertainment hub for numerous gatherings of friends and family.

On entry the living and dining areas, and well appointed kitchen with a five burner gas stove, large electric oven and stone bench tops, give way to the large bar and family area. The open plan allows a number of access points to the deck area which overlooks the sparkling pool. This is the place to sit back with a cool drink or a cuppa and take in the captivating views of the magnificent ranges, including

Type : House
Land Size : 1416 sqm
View : <https://www.samanthawilsonproperty.com.au/7967297>

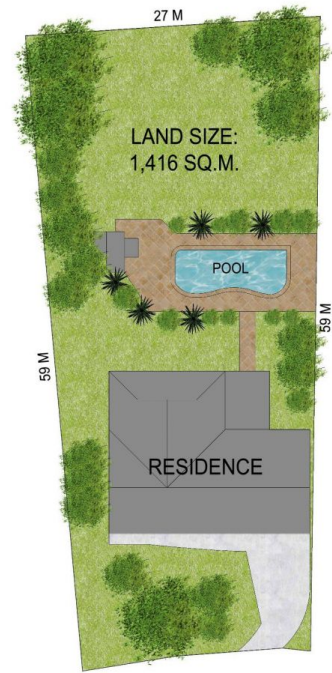

MAHERS LANE
SITE PLAN



Scale in metres. Indicative only. Dimensions are approximate. All information contained herein is gathered from sources we believe to be reliable. However we cannot guarantee its accuracy and interested persons should rely on their own enquiries.

INTERNAL : 175 SQ.M.
PATIO : 72 SQ.M.



15 Mahers Lane, Terranora