

2 Frederick Street LISMORE HEIGHTS NSW

4  2  4 

This large two storey, elevated family home has spectacular views over the Northern Ridges and will definitely impress.

First level features four generous size bedrooms with built-in robes, bathrooms with separate toilet, kitchen, dining and lounge plus laundry.

Ground level contains an extra large rumpus room, toilet, double lock-up garage with plenty of storage space.

Notable features include:

- Polished floorboards, feature wall and extra wide hallways
- Generous size bedrooms all with built in robes
- Large garden with loads of potential, plenty of room for the kids and pets
- Double lock-up garage with room for caravan and trailer

Type : House
Building : 13 sqm
Land Size : 1159 sqm
View : <https://www.samanthawilsonproperty.com.au/7967292>

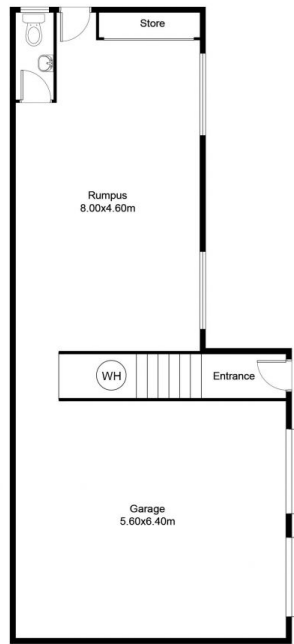

DOWNSTAIRS



UPSTAIRS

Scale in metres. Dimensions are approximate. All information contained herein is gathered from sources we believe to be reliable, however we cannot guarantee its accuracy and interested persons should rely on their own enquiries.